

DALE 50' R.O.W. AVENUE

MON
FND

DESCRIPTION:
BEING KNOWN & DESIGNATED AS LOT 2, BLOCK 12-D ON A MAP ENTITLED "SUBDIVISION PLAT, WYCKOFF PARK ESTATES, TOWNSHIP OF WYCKOFF, BERGEN COUNTY, NEW JERSEY" DATED APRIL, 1954 & FILED IN THE BERGEN COUNTY CLERK'S OFFICE ON JUNE 30, 1954 AS MAP No. 4702.

PARK 50' R.O.W. AVENUE

N25°19'00"W 125.00'

(DL. 7943 Pg. 57)
P.O.B.

190.31'

S64°41'00"W 225.98'

N64°41'00"E 301.59'

S05°51'10"W 146.09'

- CERTIFIED TO:**
- MICHAEL V. GATTONI & ERICA L. DWATEK
 - GUARANTEED RATE AFFINITY, LLC, ITS SUCCESSORS AND/OR ASSIGNS AS THEIR INTEREST MAY APPEAR
 - TRUSTED TITLE, LLC, (TITLE No. TT-20555)
 - OLD REPUBLIC NATIONAL TITLE INSURANCE COMPANY
 - SIGNATURE CLOSING SERVICES, LLC
 - MARTIN D. EAGAN, ESQ.

T.M. LOT 9
P.M. LOT 1

T.M. LOT 8
BLOCK 277
P.M. LOT 2
BLOCK 12-D
32,973.4 S.F.
0.757 AC.

T.M. LOT 7
P.M. LOT 3

JAMES P. DEADY SURVEYOR, LLC PROFESSIONAL LAND SURVEYING SERVICES 295 ROUTE 22 EAST, ONE SALEM SQUARE SUITE 202 WEST WHITEHOUSE STATION, NJ 08889 (908) 694-0145 (908) 694-0147 FAX		Scale: 1"=30' Date: 06-24-21
REVISIONS	DATE	Scale: 1"=30' Date: 06-24-21
Dwn. By: T.A.	Chk-d By: J.C.R.	FILED 270-59-1 BK 421 PG 138
TAX LOT 8-BLOCK 277 LOCATED IN THE TOWNSHIP OF WYCKOFF BERGEN COUNTY, NEW JERSEY		BY: <i>John C. Pitt</i> John C. Pitt N.J.P.L.S. Lic. No. 240504324100 Certificate No. 240504324100

- NOTES:**
1. THIS SURVEY IS PREPARED SPECIFICALLY FOR THE INDIVIDUAL(S) WHOSE TITLE AND/OR IDENTIFICATION THE UNDERSIGNED WILL NOT BE RESPONSIBLE FOR ANY ASSIGNMENT OF THIS SURVEY TO ANY PERSON NOT SO NAMED.
 2. SUBJECT TO SUCH STATE OF FACT THAT AN ACCURATE TITLE SEARCH MAY DISCLOSE.
 3. SUBJECT TO EASEMENTS AND RIGHTS-OF-WAY OF RECORD.
 4. UNDERGROUND UTILITIES ARE NOT DEPICTED. THE LACK OF UTILITY INFORMATION DOES NOT DENY THE EXISTENCE OF SAME. REFERENCE TO THE APPROPRIATE UTILITY AUTHORITY SHOULD BE MADE TO VERIFY THE PRESENCE OR EXISTENCE OF SAME.
 5. DEED REFERENCE BOOK 7943 PAGE 57, FILED IN THE BERGEN COUNTY CLERK'S OFFICE.
 6. A WRITTEN WAIVER AND DIRECTION NOT TO SET CORNER MARKERS HAS BEEN OBTAINED FROM THE VENDOR, USER PURSUANT TO P.L. 2008, C. 14 (N.J.A.C. 17:28-56.3) AND (N.J.A.C. 17:40-11.07).

FILE MAP
No. 4702

Job No. 270-59

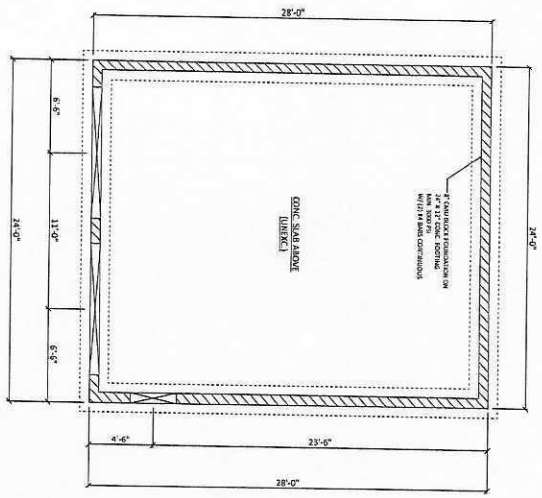

FOUNDATION PLAN
SCALE: 1/4" = 1'-0"

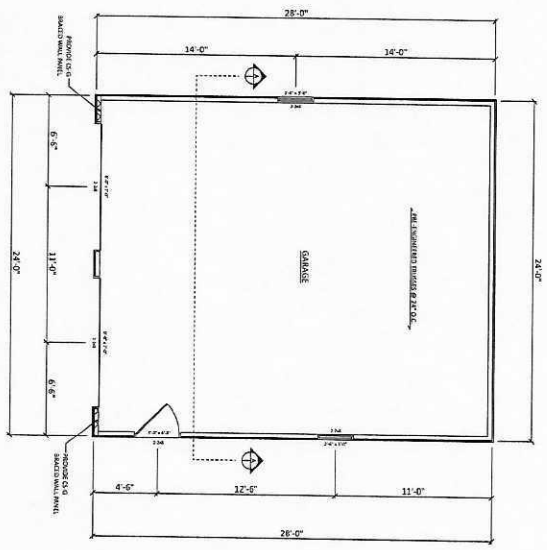

FLOOR PLAN
SCALE: 1/4" = 1'-0"

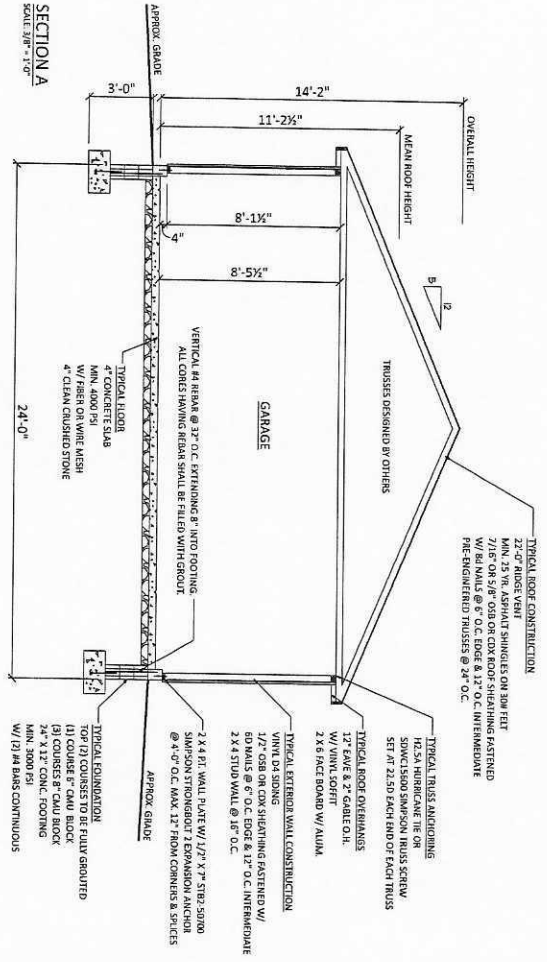

SECTION A
SCALE: 3/8" = 1'-0"

SECTION
INDICATES CONCRETE WALL PANEL
PROVIDED FOR 2\"/>

SECTION
INDICATES CONCRETE WALL PANEL
PROVIDED FOR 2\"/>

DRAFTING
C. O. N. C. E. T. S.
5215 Old York Road
Lancaster, PA 17303-5225
P: 717-444-2500 F: 717-393-0225
www.drafting.com

CONTRACTOR:
Amish Built, Inc.
424 Columbia Ave.
Lancaster, PA 17303
717-652-8527

CLIENT NAME & ADDRESS:
Michael Gotton/
47 Dale Ave
Wyckoff, NJ 07481

PROJECT TITLE:
NEW GARAGE

SHEET NO.:
Floor plan
8/29/21

SCALE:
AS NOTED
DS75-21

Skyrocket Junipers
Juniperus Virginiana 'Skyrocket'

- Dense greenery for areas with little space
- Drought resistant
- Virtually maintenance free
- Remains vibrant with its rich blue-green color, no brown fading
- Nearly a foot of growth or more per year
- Skyrockets are pest-free

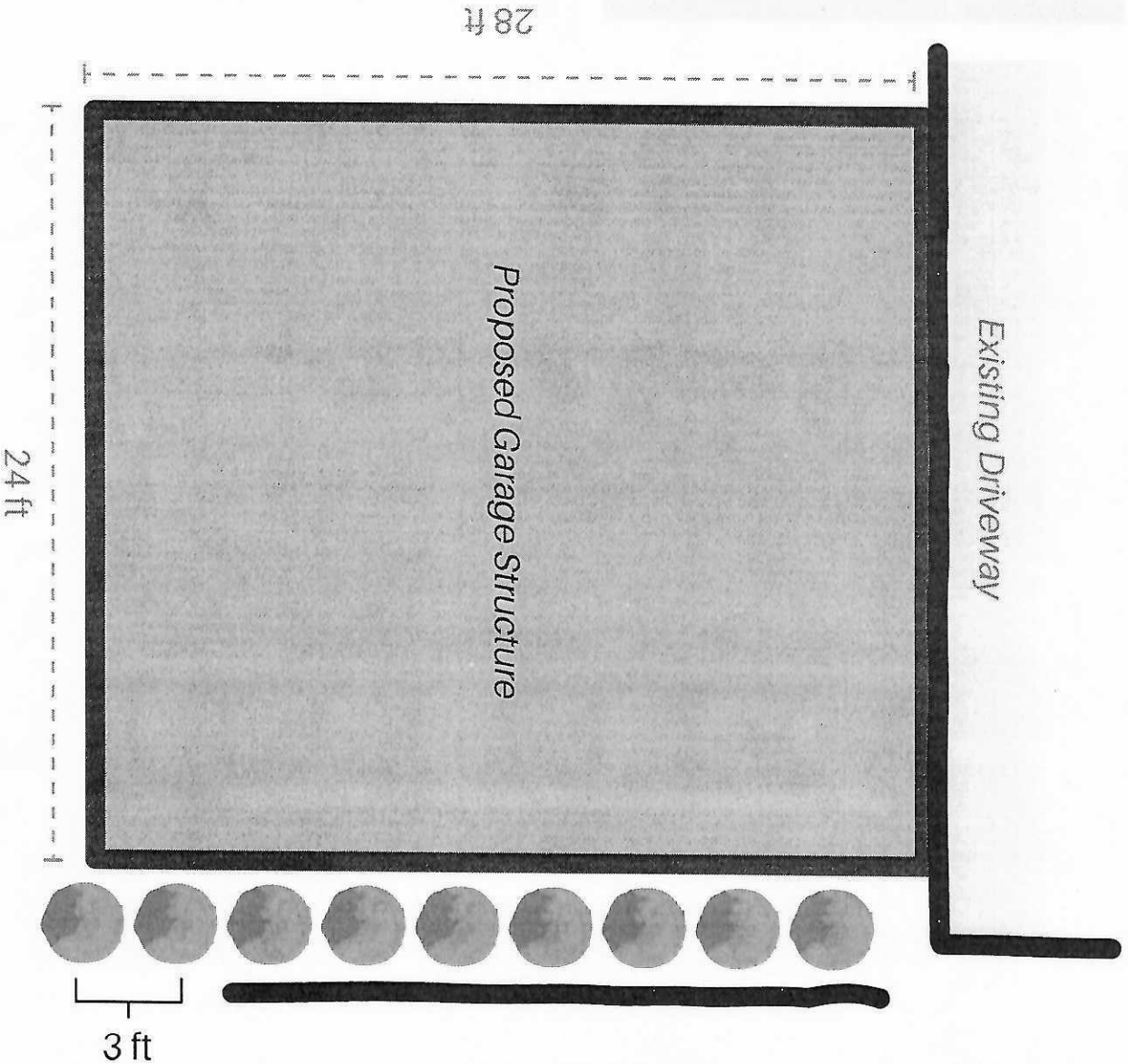

*This is an artistic rendering to show planned landscaping. Do not scale dimensions off drawings. Use written or calculated dimensions for final plantings.



Skyrocket Junipers
Juniperus Virginiana 'Skyrocket'

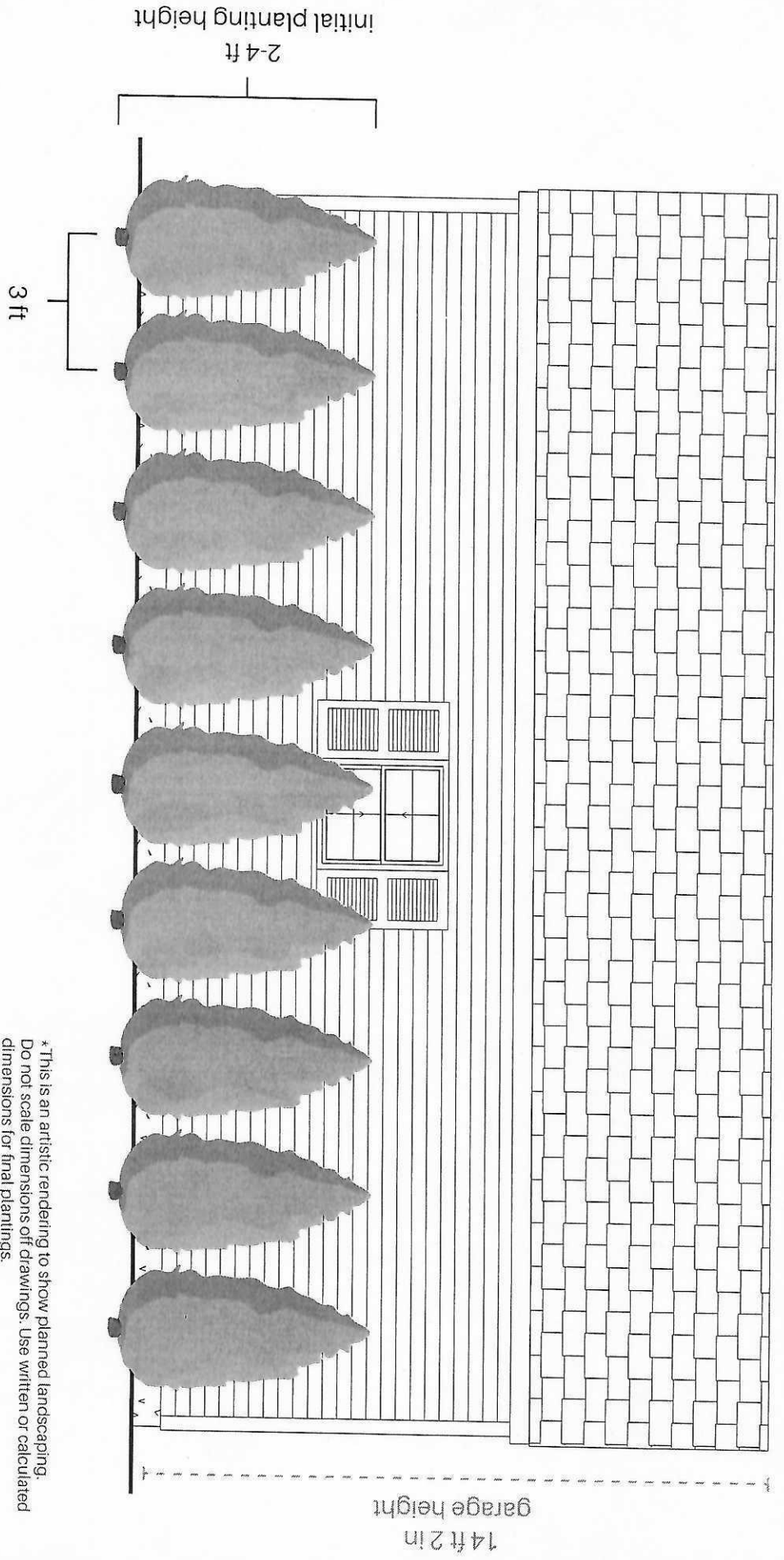

* This is an artistic rendering to show planned landscaping. Do not scale dimensions off drawings. Use written or calculated dimensions for final plantings.



Skyrocket Junipers
Juniperus Virginiana 'Skyrocket'

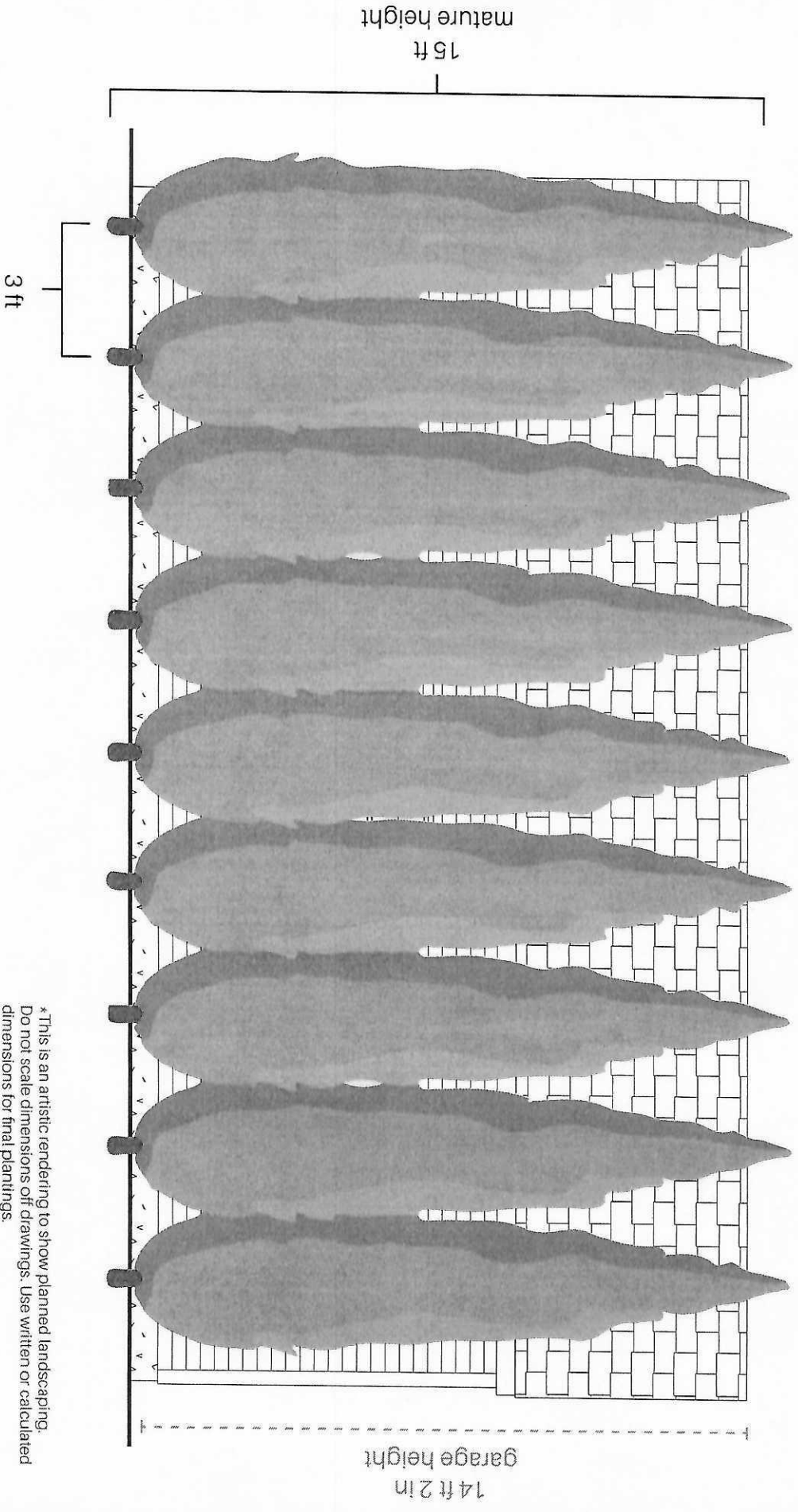

* This is an artistic rendering to show planned landscaping. Do not scale dimensions off drawings. Use written or calculated dimensions for final plantings.